



Liquid Sunshine®
OUTDOOR PRODUCTS



SOLID WALL VINYL

SHOWER ENCLOSURE KITS

Patented Maintenance Free Vinyl Outdoor Shower Enclosures
US Patent #D673,659



ONLINE: OUTSIDESHOWER.COM

PH: 1-844-743-5140

EACH SHOWER ENCLOSURE INCLUDES ONE DOOR THAT CAN HINGE OFF ANY POST

CHOOSE YOUR LAYOUT

PARK MODEL **3 x 3 ENCLOSURE**

34-1/2" WIDE DOOR

OPTIONAL 4th WALL REQUIRES SPECIAL ORDER

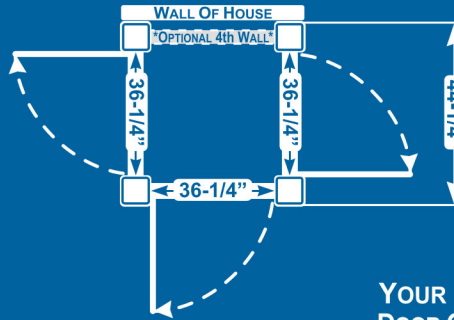

YOUR CHOICE OF DOOR LOCATION
DOOR CAN BE PLACED LEFT OR RIGHT

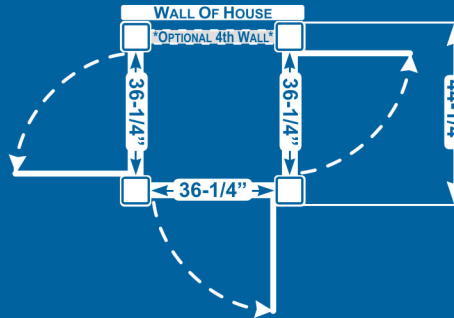

100 SERIES **4 x 4 ENCLOSURE**

40-1/2" WIDE DOOR

OPTIONAL 4th WALL REQUIRES SPECIAL ORDER

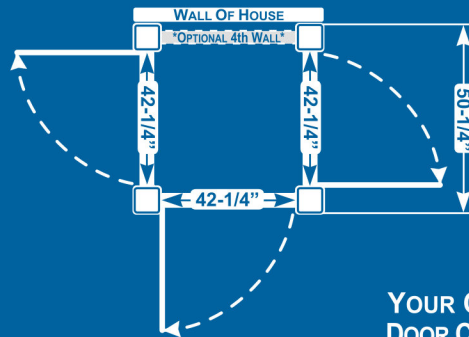

YOUR CHOICE OF DOOR LOCATION
DOOR CAN BE PLACED LEFT OR RIGHT

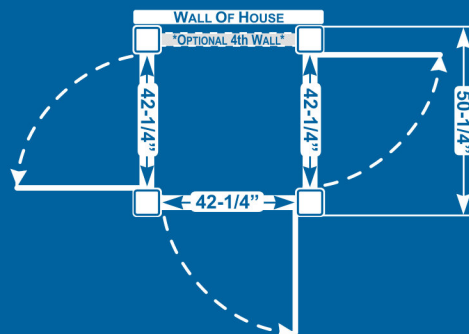

3 COLORS - CUSTOMIZABLE LAYOUTS - QUICK INSTALLATION

CHOOSE YOUR LAYOUT

200 SERIES 4 x 6 ENCLOSURE

40-1/2" WIDE DOOR

OPTIONAL 4th WALL REQUIRES SPECIAL ORDER

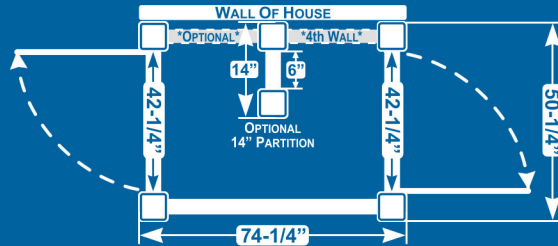

YOUR CHOICE OF DOOR LOCATION
DOOR CAN BE PLACED LEFT OR RIGHT

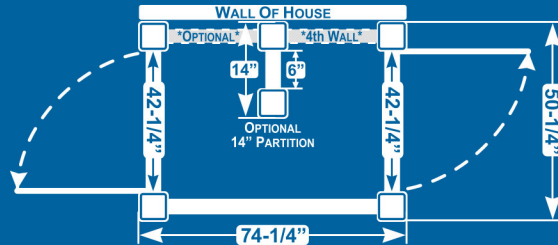

300 SERIES 4 x 6 ENCLOSURE

34-1/2" WIDE DOOR

OPTIONAL 4th WALL REQUIRES SPECIAL ORDER

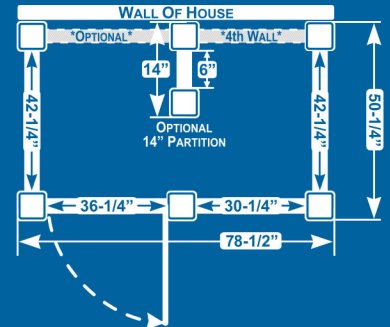
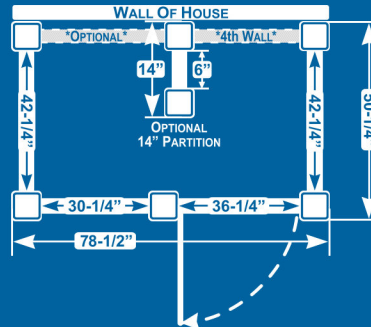

YOUR CHOICE OF DOOR LOCATION
DOOR CAN BE PLACED LEFT OR RIGHT

MAINTENANCE FREE VINYL - CAN BE INSTALLED ON CONCRETE OR WOOD

CHOOSE YOUR LAYOUT

400 SERIES 4 x 8 ENCLOSURE

40-1/2" WIDE DOOR

OPTIONAL 4th WALL REQUIRES SPECIAL ORDER

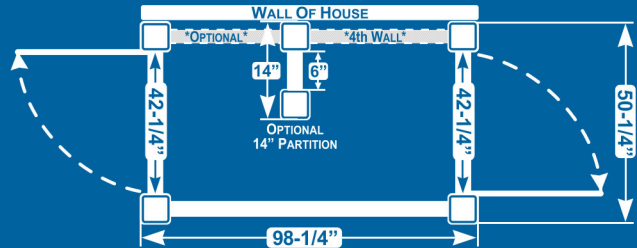

YOUR CHOICE OF DOOR LOCATION
DOOR CAN BE PLACED LEFT OR RIGHT

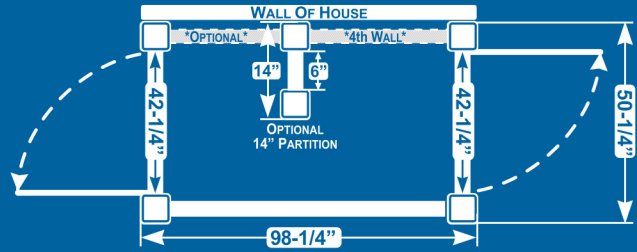

500 SERIES 4 x 8 ENCLOSURE

40-1/2" WIDE DOOR

OPTIONAL 4th WALL REQUIRES SPECIAL ORDER

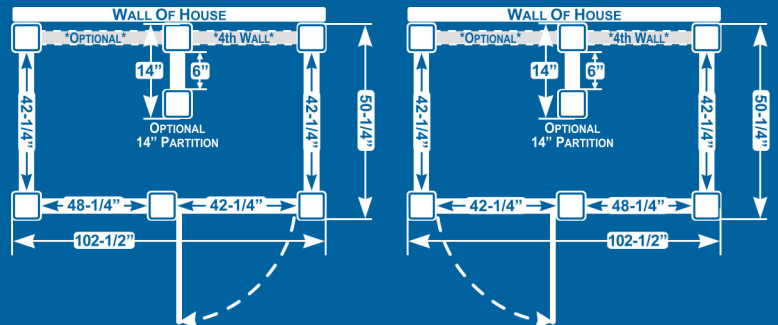

YOUR CHOICE OF DOOR LOCATION
DOOR CAN BE PLACED LEFT OR RIGHT

CHOOSE YOUR OPTIONS

COLORS

WHITE 

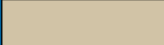
TAN 

KHAKI 

POST CAPS



NEW ENGLAND CAP



FLAT CAP

LOUVERED ROOF



PERGOLA ROOF ACCENT

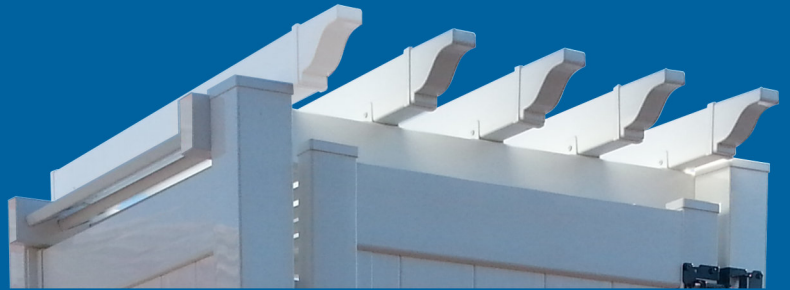

BENCH



14" PARTITION

14" Partition is available for the following models:

200 Series

300 Series

400 Series

500 Series



TOWEL RACK



STRUCTURAL POST MOUNTS

Shower Enclosures installed on top of wood or concrete require Structural Post Mounts for installation. Structural Post Mounts are **not** included with the Shower Enclosure Kits by default and **must** be selected as an additional option.

FOR INSTALLING SHOWER ENCLOSURES ON TOP OF WOOD OR CONCRETE

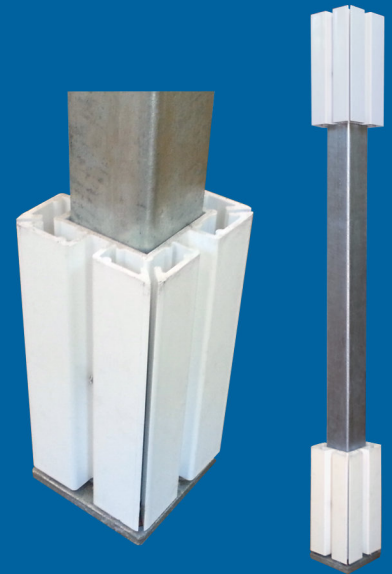

Park Model / 100 Series	QTY 4
200 / 400 Series	QTY 4
200 / 400 Series w/ Optional 14" Partition	QTY 6
300 / 500 Series	QTY 5
300 / 500 Series w/ Optional 14" Partition	QTY 7

FREQUENTLY ASKED QUESTIONS

What Is Required When Installing On Top Of Wood Or Concrete?

Structural Post Mounts Are Required For Installations On Top Of A Wood Or A Concrete Surface. They Fit Inside Of The Shower Enclosure Posts and Secure The Shower Enclosure To The Installation Surface. Structural Post Mounts Are **Not** Included With The Shower Enclosure Kits By Default and **Must** Be Selected As An Additional Option.

*****See "Structural Post Mounts" Above For More Information.*****

Can I Order A Fourth Wall?

Yes. But, Usually The Wall Of The House Is Used "As Is" Without The Fourth Wall.

What Is Included In A Standard Kit?

Walls, Mounting Brackets, Posts, Door, and Door Hardware Only.
Walls and Door Do Not Come Pre-Assembled.

How Do I Buy This?

All Shower Enclosure Components Come Packaged In Cardboard Boxes For Easy Transportation and Quick Installation.

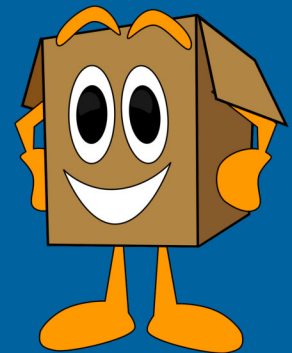

ONLINE:
OUTSIDESHOWER.COM

PHONE:
1-844-743-5140